

JOB

Subway Station

14017-B

P.O.

Santiago de Chile,
Chile

LOCATION

IDOM

CLIENT

7,850 m²

AREA / LENGTH

17.5 M\$
5.25 M\$

GLOBAL BUDGET
(OF THE TASKS UNDERTAKEN)

Structural engineering,
drawing and
documents.

TASKS UNDERTAKEN

2014

DATE

DESCRIPTION

The "Los Leones" Station is one of the new stations belonging to the extension of Lines 3 and 6, in Santiago. IDOM is responsible for the architectural design and structural engineering, and 3D3 INGENIERÍA has been contracted to carry out some of the tasks, which include:

- Designing of the beams, slabs, retaining walls, stair slabs and pillars
- Delineating reinforced elements
- Counting and classifying reinforcement bars
- Writing the reports

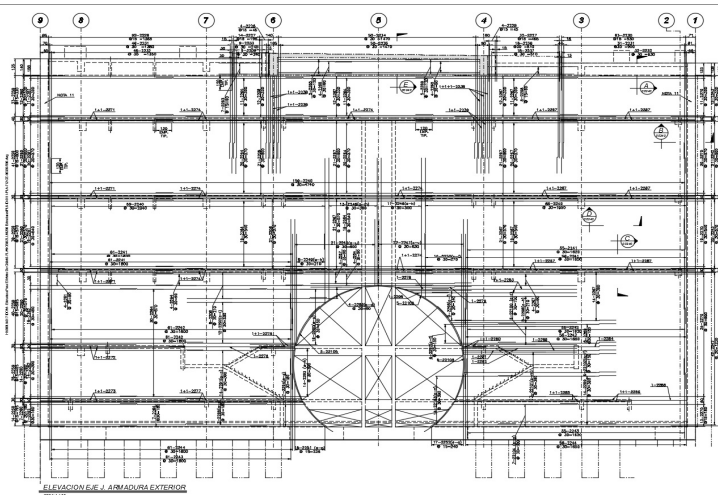
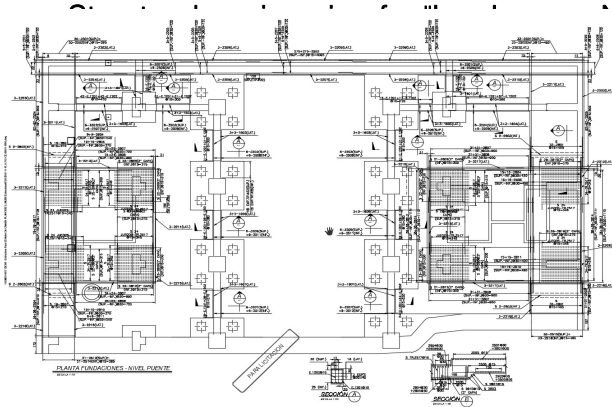
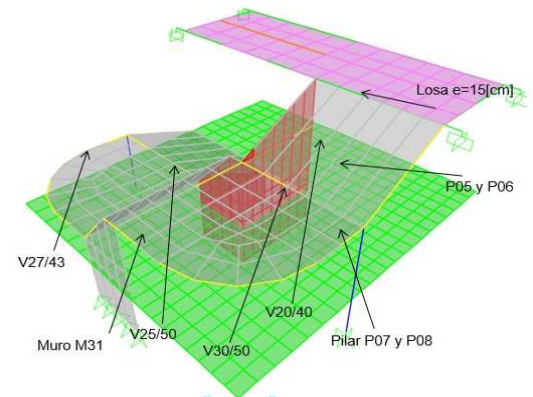

Fo